

Copper-Nickel Flanges

Socket Weld Commercial Flange, Class 150

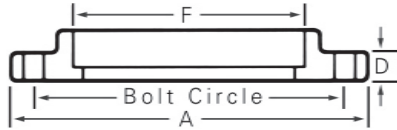

- Dimensions per ANSI B16.5.
- Flanges normally supplied with bore for Class 200 pipe per MIL-T-16420.
- Raised faces are available.

Nominal Pipe Size	A	D	F	Number of Holes	Hole Diameter	Bolt Circle	Weight	90-10 Part Number	70-30 Part Number
1/2	3.50	.438	.880	4	5/8	2.375	1	580945	581242
3/4	3.875	.500	1.090	4	5/8	2.75	2	581145	581250
1	4.25	.563	1.355	4	5/8	3.125	2	581153	581349
1 1/4	4.625	.625	1.700	4	5/8	3.50	3	581161	581357
1 1/2	5.00	.688	1.950	4	3/4	3.875	4	581179	581365
2	6.00	.750	2.440	4	3/4	4.75	6	581187	581373
2 1/2	7.00	.875	2.940	4	3/4	5.50	9	581195	581381
3	7.50	.938	3.570	4	3/4	6.0	11	581200	581399
4	9.00	.938	4.570	8	3/4	7.5	14.5	581218	581404
5	10.0	.938	5.660	8	7/8	8.5	17	581226	581412
6	11.0	1.0	6.720	8	7/8	9.5	20	581234	581420

Socket Weld Commercial Flange, Class 300

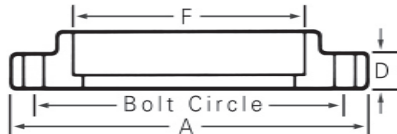

- Dimensions per ANSI B16.5.
- Flanges normally supplied with bore for Class 200 pipe per MIL-T-16420.
- Raised faces are available.

Nominal Pipe Size	A	D	F	Number of Holes	Hole Diameter	Bolt Circle	Weight	90-10 Part Number	70-30 Part Number
1/2	3.75	.563	.88	4	5/8	2.625	2	495912	590762
3/4	3.625	.625	1.09	4	3/4	3.25	3	590673	590770
1	4.875	.688	1.36	4	3/4	3.5	3	590681	590788
1 1/4	5.25	.75	1.70	4	3/4	3.875	5	590699	590796
1 1/2	6.125	.813	1.95	4	7/8	4.5	7	590704	590801
2	6.5	.875	2.44	8	3/4	5	7	590712	590819
2 1/2	7.5	1	2.94	8	7/8	5.875	10	404000	590827
3	8.25	1.125	3.57	8	7/8	6.625	13	590720	590835
4	10	1.25	4.57	8	7/8	7.875	24	590738	590843
5	11	1.375	5.66	8	7/8	9.25	29	590746	590851
6	12.5	1.438	6.72	12	7/8	10.625	36	590754	590869

Sizes not shown available upon request.