

Copper-Nickel Flanges

Socket Weld Navy Flange, 150 Pound Class

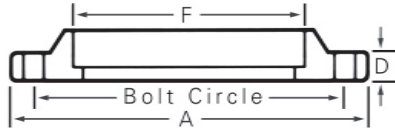

- Drilling, flange thickness and diameter per MIL-F-20042.
- Hub and socket per NAVSEA 810-4715319 for 1 1/4 NPS and above; per ANSI B16.5 for 1/2 to 1 NPS.

Nominal Pipe Size	A	D	F	Number of Holes	Hole Diameter	Bolt Circle	Weight	90-10 Part Number	70-30 Part Number
1	4.25	.438	1.355	4	9/16	3.125	2	581446	581535
1 1/4	4.5	.438	1.70	4	9/16	3.375	2	581454	581357
1 1/2	5.063	.438	1.950	6	9/16	3.938	3	581462	581543
2	5.563	.438	2.411	6	9/16	4.438	3	581438	581569
2 1/2	6.125	.500	2.913	6	9/16	5.000	4	581470	581577
3	6.625	.500	3.543	8	9/16	5.500	4.5	581488	581527
4	7.688	.500	4.552	8	9/16	6.563	6	581496	581585
5	9.063	.563	5.62	10	11/16	7.813	8.5	581501	581593
6	10.125	.563	6.682	12	11/16	8.875	10	581519	581608

Socket Weld Navy Flange, 250 Pound Class

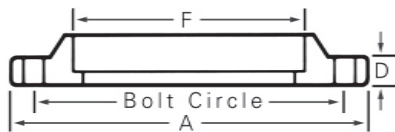

- Drilling, flange thickness and diameter per MIL-F-20042.
- Hub and socket per NAVSEA 810-4715319 for 2 NPS and above; per ANSI B16.5 for 1/2 to 1 1/2 NPS.

Nominal Pipe Size	A	D	F	Number of Holes	Hole Diameter	Bolt Circle	Weight	90-10 Part Number	70-30 Part Number
2	5.563	.813	2.411	6	11/16	4.438	5.0	294227	581674
2 1/2	6.125	.938	2.913	6	11/16	5.000	6.5	581624	581682
3	6.625	.938	3.543	8	11/16	5.500	7.0	581632	581690
4	7.688	1.000	4.552	8	11/16	6.563	10.5	581640	581705
5	9.063	1.063	5.620	10	11/16	7.813	15.0	581658	581713
6	10.125	1.188	6.682	12	11/16	8.875	20.5	294633	581721

Sizes not shown available upon request.