

## SK-40 and SK-40-P Steel Backing Flanges

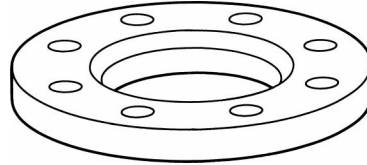
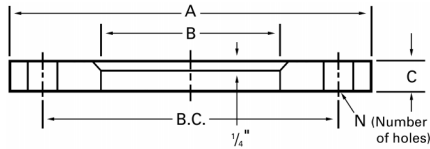

- Designed for situations where a standard cast steel backing flange cannot be used.
- Made from carbon steel plate per ASTM A 36.
- Drilled hole patterns per ANSI B16.1, Class 125 or Class 250 (identical to ANSI B16.5, Class 150 or Class 300 through 24" size).
- Coated with red oxide primer. Galvanized, epoxy and other coatings are also available.
- Can be manufactured in non-standard sizes, drill patterns and thicknesses.
- Alaskan SK-40 and SK-40-P steel backing flanges can be used with any of the Alaskan slip-on or butt welding stub ends.

### SK-40

Drilling per Class 125

Made to Fit With OD Tube Size Stub Ends

Tube OD	2	2 1/2	3	4	5	6	8	10	12	14	16	18	20	24	30	36	42	48
A (OD)	6	7	7 1/2	9	10	11	13 1/2	16	19	21	23 1/2	25	27 1/2	32	38 3/4	46	53	59 1/2
B (ID)	2 1/4	2 7/8	3 1/4	4 1/4	5 3/8	6 3/8	8 3/8	10 3/8	12 3/8	14 1/2	16 5/8	18 5/8	20 5/8	24 5/8	30 5/8	36 5/8	42 5/8	48 5/8
C (THK)	1/2	1/2	1/2	1/2	1/2	5/8	5/8	5/8	3/4	3/4	3/4	3/4	3/4	3/4	1	1	1 1/8	1 1/4
B.C.	4 3/4	5 1/2	6	7 1/2	8 1/2	9 1/2	11 3/4	14 1/4	17	18 3/4	21 1/4	22 3/4	25	29 1/2	36	42 3/4	49 1/2	56
Hole Size	3/4	3/4	3/4	3/4	7/8	7/8	7/8	1	1	1 1/8	1 1/8	1 1/4	1 1/4	1 3/8	1 3/8	1 5/8	1 5/8	1 5/8
N	4	4	4	8	8	8	8	12	12	12	16	16	20	20	28	32	36	44
Weights	3.1	4.2	4.7	6.3	7.1	9.9	14.2	18.3	31.8	35.6	42	43	50	63	113	153	247	294

Drilling per Class 250

Tube OD	2	2 1/2	3	4	5	6	8	10	12	14	16	18	20	24	30	36	42	48
A (OD)	6 1/2	7 1/2	8 1/4	10	11	12 1/2	15	17 1/2	20 1/2	23	25 1/2	28	30 1/2	36	43	50	57	65
B (ID)	2 3/8	2 7/8	3 3/8	4 3/8	5 3/8	6 1/2	8 1/2	10 1/2	12 1/2	14 1/2	16 5/8	18 5/8	20 5/8	24 5/8	30 5/8	36 5/8	42 5/8	48 5/8
C (THK)	5/8	5/8	5/8	3/4	3/4	7/8	7/8	7/8	1	1	1	1	1	1 1/8	1 1/4	1 1/4	1 3/8	1 1/2
B.C.	5	5 7/8	6 5/8	7 7/8	9 1/4	10 5/8	13	15 1/4	17 3/4	20 1/4	22 1/2	24 3/4	27	32	39 1/4	46	52 3/4	60 3/4
Hole Size	3/4	7/8	7/8	7/8	7/8	7/8	1	1 1/8	1 1/4	1 1/4	1 3/8	1 3/8	1 3/8	1 5/8	1 7/8	2 1/8	2 1/8	2 1/8
N	8	8	8	8	8	12	12	16	16	20	20	24	24	24	28	32	36	40
Weights	4.4	5.8	6.9	12.4	14.2	20.2	27.2	34.0	52.9	63.6	74.4	86.7	102	156	225	281	388	560

### SK-40-P

Drilling per Class 125 or 250

Made to Fit With Nominal Pipe Size Stub Ends (Identical to SK-40 Except for B Dimension.)

Nominal

Pipe Size	2	2 1/2	3	4	5	6	8	10	12	14 thru 48 see SK-40
Pipe OD	2 3/8	2 7/8	3 1/2	4 1/2	5 9/16	6 5/8	8 5/8	10 3/4	12 3/4	
B (ID)	2 5/8	3 1/8	3 3/4	4 3/4	5 7/8	7	9	11 1/8	13 1/8	
Weights (125)	3.2	4.0	4.3	6.3	6.4	9.0	13.1	15.3	29.2	
Weights (250)	4.2	5.0	6.6	11.8	13.3	18.9	25.7	31.3	50.3	

Dimensions are in inches. All weights are in pounds based on a metal density of .2836 lb/in<sup>3</sup>

When ordering galvanized flanges, specify SK-40G or SK-40-PG.